

PLASTIC PLUG

PLASTIC PLUG

Plastic Plug is the accepted method of light weight screw fixing into solid material.

FOR FIXING TO

Concrete, Natural Stone, Solid Brick Assonny, limited use also in cavity and Checker bricks, as well as in light construction building material.

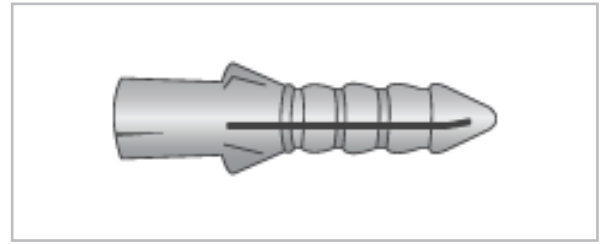

RANGE OF USE

Quick installation plug for screws. Owing to its special design it is particularly suitable for all type of screws

INSTALLATION

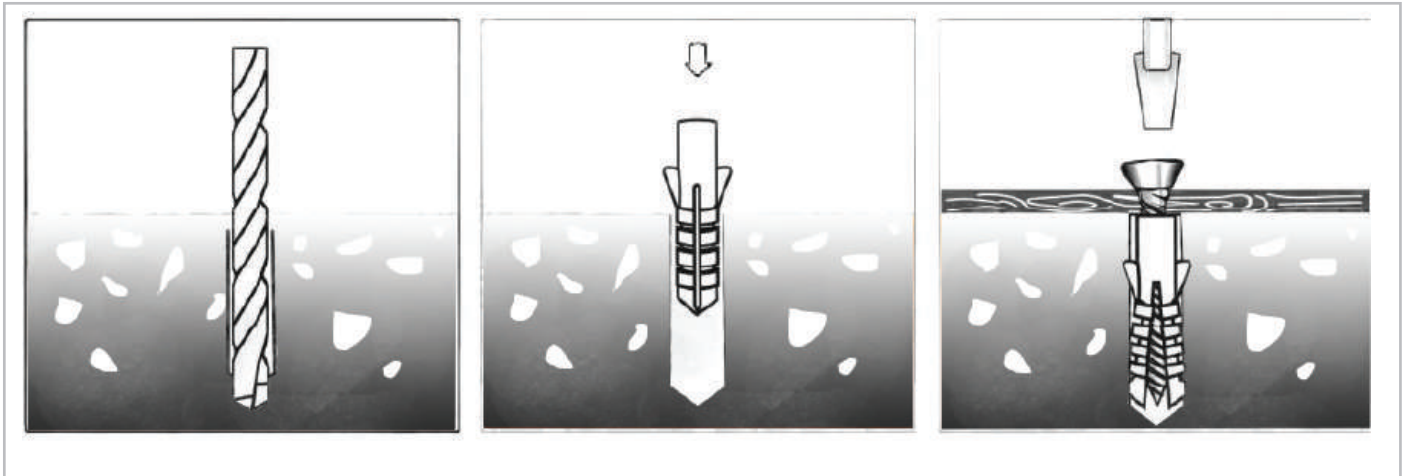

Drill concrete diameter hole to recommended depth.

Insert Plastic Plug

Tighten using a screw driver until the head of the screw is flush with the collar of the anchor.

PLASTIC PLUG

PLASTIC PLUG

Anchor Size	Anchor Length (mm)	Hole Diameter Ø (mm)	Packed Quantity (Bag)	Part No.
M5 (#5)	25	5	1kgs	PP05000WH
M6 (#6)	30	6	1kgs	PP06000WH
M7 (#7)	35	7	1kgs	PP07000WH
M8 (#8)	40	8	1kgs	PP08000WH

Anchor Length	Drill Ø	Min. Drill Depth	Gauge	Concrete 25MPa (N)	Rec. Working Load (kN) See Safety Factors p.2			
					Solid Brickwork 15MPa (N)	Cavity Bricks 15MPa (N)	Light Construct Walls 5MPa (N)	Light Construct Walls 2.5MPa (N)
25	5	35	5-7	300	300	200	80	40
30	6	40	6-9	500	500	250	120	80
35	7	50	9-12	650	650	320	155	100
40	8	55	10-14	800	800	250	200	150

Anchor Size	Tapping Screw Size	Anchor Length (mm)	Hole Diameter Ø (mm)	Packed Quantity (Box)	Part No.
M5 (#5)	#5x1"	25	5	100	SE-PE05000ZP
M6 (#6)	#6 x 1"	30	6	100	SE-PE06000ZP
M7 (#7)	#7 x 1"	35	7	100	SE-PE07000ZP
M8 (#8)	#8 x 1.1/2"	40	8	100	SE-PE08000ZP

